

# THE CITY OF NAPOLEON

BUILDING & ZONING DEPARTMENT  
255 W. RIVERVIEW  
(419)592-4010

## Building Permit

Permit Number: BP2007-147

Page 1 of 1

Printed: 9/25/2007

### ADDRESS:

**980 Melody Lane**

### Applicant

Name: Cynthia Celani  
Address: 980 Melody Ln

Approval Date: 9/25/2007  
419-599-1274

### Owners

Name: Ms. Cynthia Celani  
Address: 980 Melody Ln  
Metamora, OH 43545

Phone: 419-599-1274

### Contractors

#### Fees and Receipts:

Number	Description	Amount
FEE2007-535	Building Permit Fee (Auto)	\$10.00
FEE2007-536	State 1% fee (Calc)	\$0.10
<b>Total Fees:</b>		<b>\$10.10</b>
RCPT2007-417		\$10.10
<b>Total Receipts:</b>		<b>\$10.10</b>

6' fence

APPLICANTS SIGNATURE:

*Cynthia Celani*

DATE:

9.24.07

REMINDER: YOU MUST CALL (419)592-4010 FOR AN INSPECTION



# CITY OF NAPOLEON GENERAL PERMIT APPLICATION

THIS APPLICATION IS FOR RESIDENTIAL CONSTRUCTION INCLUDING BUILDING, ELECTRICAL, PLUMBING, MECHANICAL, DEMOLITIONS, REMODELING.

DATE: \_\_\_\_\_ JOB LOCATION: \_\_\_\_\_

OWNER: Cynthia Celami PHONE: 419-599-1274

OWNER ADDRESS: 980 Melody Ln. CITY: Nap ZIP: 43545

CONTRACTOR: Self

PHONE #: \_\_\_\_\_ CELL PHONE#: \_\_\_\_\_

CONTRACTOR LICENSED WITH THE CITY OF NAPOLEON?: YES  NO:

Is any of the above job going to be subcontracted out? Yes  No:

If yes to whom: \_\_\_\_\_

DESCRIPTION OF WORK TO BE PERFORMED: Fence 6'

ESTIMATED COMPLETION DATE: \_\_\_\_\_

### PLEASE MARK THE TYPE OF WORK YOU WILL BE PERFORMING

- |  |   |
|--|---|
| <input type="checkbox"/> A/C ADD ON 1%                 | <input type="checkbox"/> REMODELING 1%            |
| <input type="checkbox"/> BOILER REPLACEMENT 1%         | <input type="checkbox"/> ROOFING 1%               |
| <input type="checkbox"/> CURBING                       | <input type="checkbox"/> SEWER REPAIRS**          |
| <input type="checkbox"/> DECKS * 1%                    | <input type="checkbox"/> SIDEWALK*                |
| <input type="checkbox"/> DRIVEWAY*                     | <input type="checkbox"/> SIDING 1%                |
| <input type="checkbox"/> ELECTRICAL SERVICE UPGRADE 1% | <input type="checkbox"/> SHED* (under 200 sq ft)  |
| <input type="checkbox"/> ELECTRICAL SERVICE NEW 1%     | <input type="checkbox"/> SHED* (over 200 sqft) 1% |
| <input type="checkbox"/> SWIMMING POOL*1%              | <input checked="" type="checkbox"/> FENCE*        |
| <input type="checkbox"/> FURNACE REPLACEMENT 1%        | <input type="checkbox"/> TEMP ELECTRIC 1%         |
| <input type="checkbox"/> ADDITIONS* 1%                 | <input type="checkbox"/> FURNACE NEW 1%           |
| <input type="checkbox"/> WATER TAP (size _____")       | <input type="checkbox"/> WINDOWS /DOORS 1%        |
| <input type="checkbox"/> LAWN METER 1%                 |   |
| <input type="checkbox"/> PLUMBING 1%                   |   |

### 1%- EFFECTIVE JUNE 1, 2007 BOARD OF BUILDING STANDARDS FEE

\*PLEASE INCLUDE A PICTURE SHOWING MEASUREMENTS FROM EXISTING STRUCTURES AND PROPERTY LINES. INDICATING THE TYPE OF WORK YOU WISH TO PERFORM.

\*\* IF WORK REQUIRES GOING INTO THE STREET A STREET BOND IS REQUIRED!

FOR PERMIT COSTS PLEASE FILL OUT REVERSE SIDE.

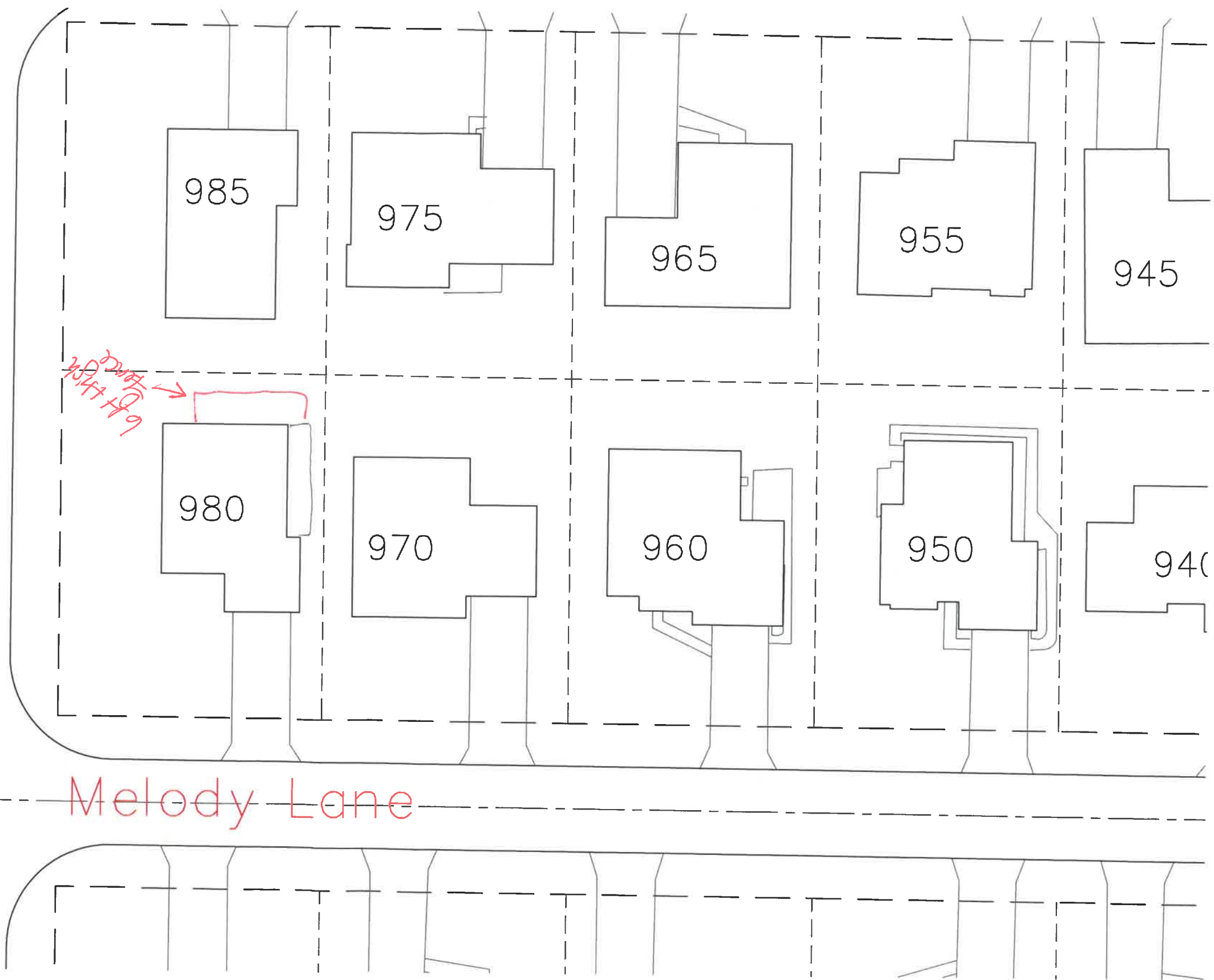
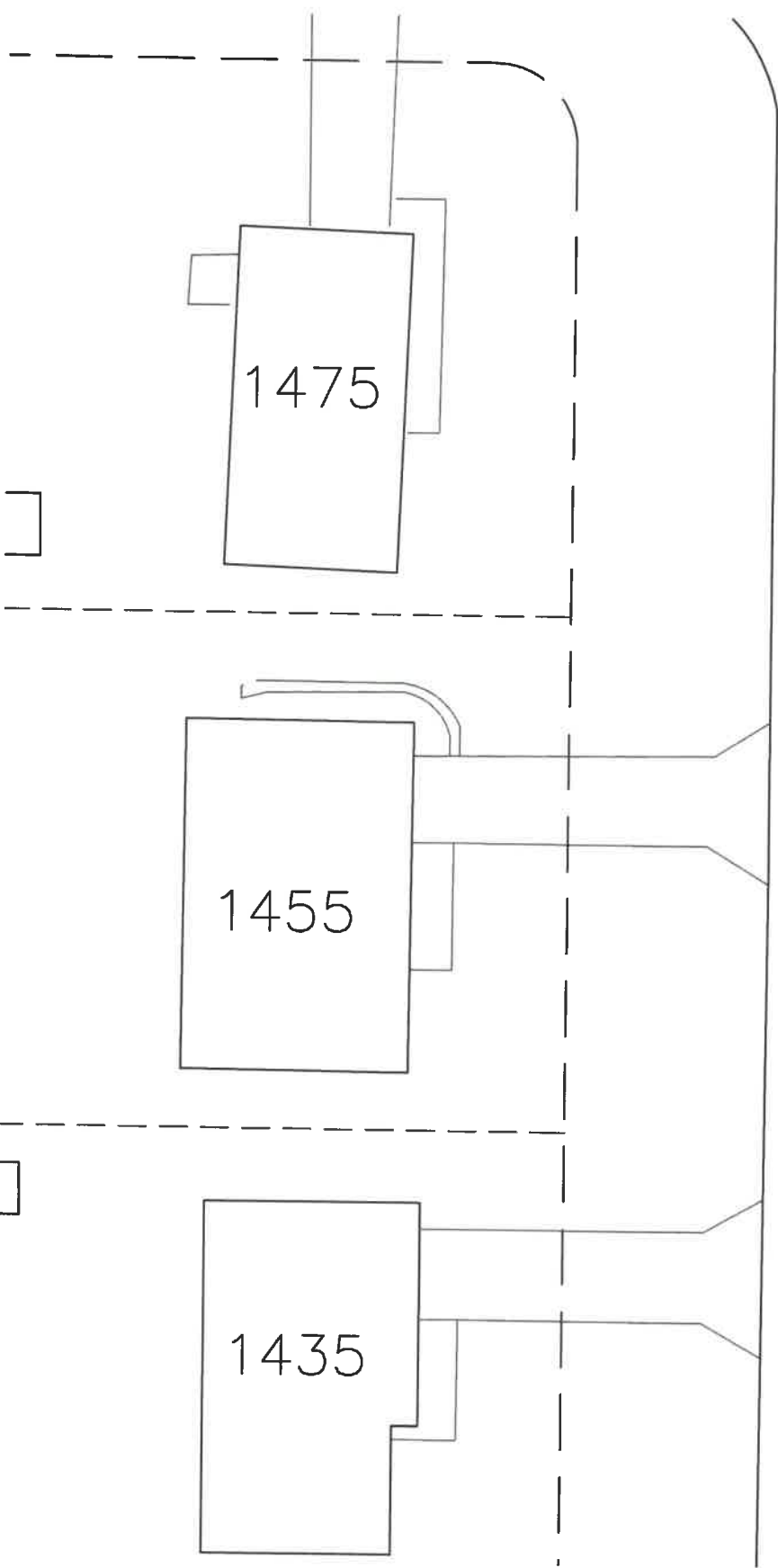

ue

Melody Lane